

HDH2228H

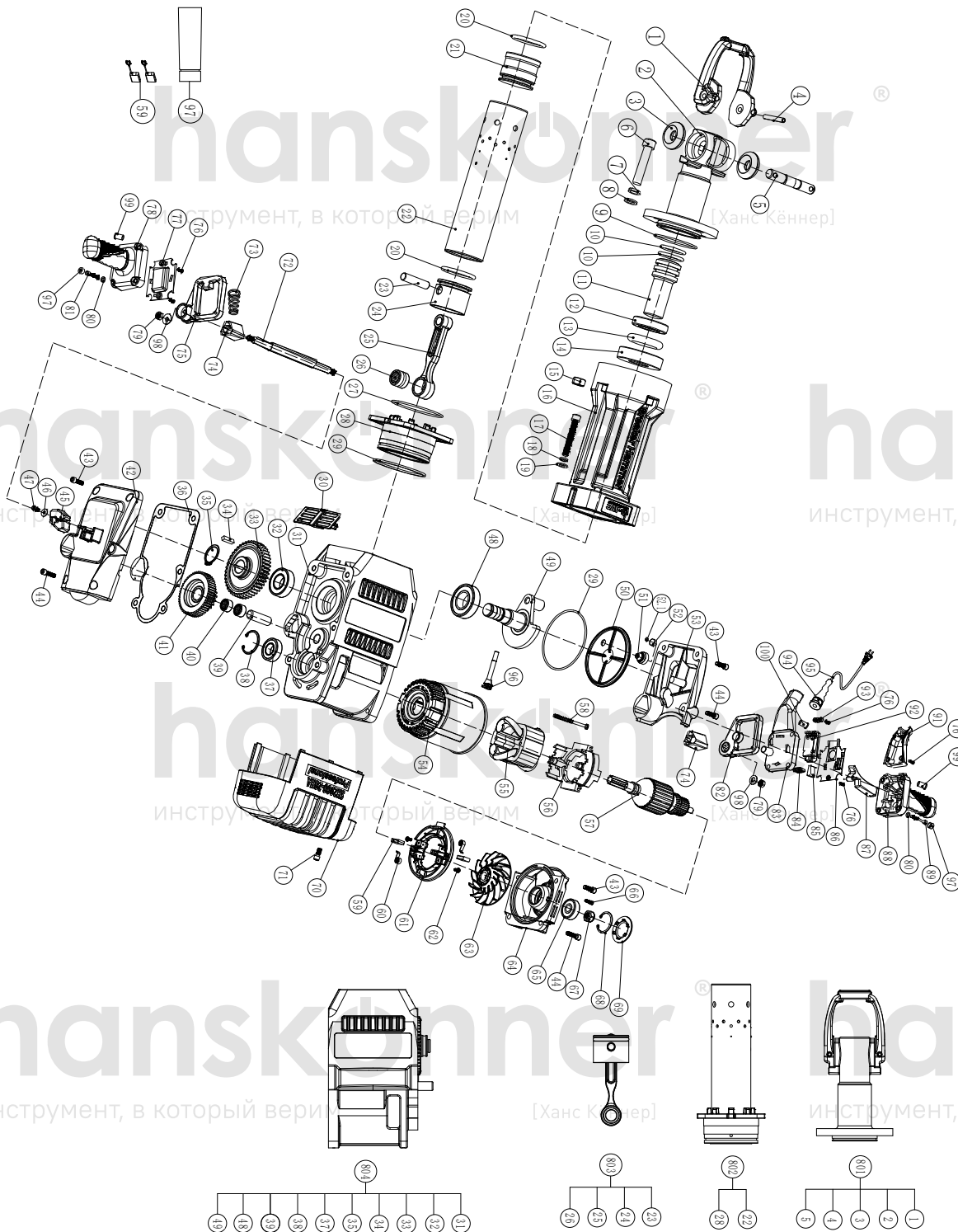

No.	Description	No.	Description
1	Chisel Chuck	54	Stator Ass'y
2	Front Cover	55	Stator 220-240V
3	Lock ring	55	Stator 110-120V
4	Spring Column Pin	56	Positioning Bracket
5	Locking Lever	57	Armature 220-240V
6	Hex. Socket Bolt M14×70 (12.9)	57	Armature 110-120V
7	Φ14 Spring Washer	58	Tapping Screw ST4.8×70×35
8	Φ14 Flat Washer	59	Carbon Brush 220-240V
9	O Ring Φ77×Φ2.9	59	Carbon Brush 110-120V
10	Fluorin O RingΦ39×Φ5	60	Coil spring
11	Impact Hammer	61	Carbon Brush bracket Subassembly
12	Hammer ring	62	Machine Screw M4×8
13	Shock Absorption Ferrule	63	Fan
14	locking Ring	64	Bearing Cover
15	M14 Six Nut	65	Ball Bearing 6301ZVCW
16	Aluminum Head	66	Hex. Socket Bolt M6×20 (12.9)
17	Hex. Socket Bolt M10×70 (12.9)	67	M12×1 Anti-Loosing Nut
18	Φ10 Spring Washer	68	Φ37 Retaining Ring
19	Φ10 Flat Washer	69	Decorative cover
20	Fluorin O RingΦ53.8xΦ6	70	Cover
21	Impact Piston	71	Hex. Socket Bolt M6×15 (12.9)
22	Cylinder	72	Mandrel Subassembly
23	Piston Pin Φ14×61.5	73	Shock Absorption Spring
24	Piston	74	Support
25	Connecting Rod Ass'y	75	Side Handle Support
26	Needle Bearing 202823	76	Tapping Screw ST4.2×16
27	O RingΦ100x3.1	77	Side Handle Cover
28	Cylinder Seat	78	Side Handle Ass'y
29	O RingΦ87×Φ3.5	79	M10 Anti-Loosing Nut
30	Decorative cover	80	Φ6 Flat Washer
31	Housing Ass' y	81	Hex. Socket Bolt M6×35
32	Ball Bearing 6205DD	82	Main Handle Support
33	Final Gear	83	Side Handle Ass'y Base
34	Palt Key 4×18	84	0.18μH Electricity Feels
35	Φ24 Retaining Ring	85	0.33μF Electric Capacity
36	Paper Washer	86	Switch Cover
37	NSK 6004 Ball Bearing	87	Switch Trigger
38	Φ42 Retaining Ring	88	Main Handle
39	Double teeth Pin Φ16×50	89	Hex. Socket Bolt M6×50
40	Needle Bearing HK1612	91	Main Handle Cover
41	Double teeth	92	Switch
42	Gear Cover	93	Cord Clip
43	Hex. Socket Bolt M8×20 (12.9)	94	Cord Armor
44	Hex. Socket Bolt M8×25 (12.9)	95	Cord
45	Stop Block	96	Wire Cover
46	Φ5 Flat Washer	97	Screw sleeve
47	Hex. Socket Bolt M5×12 (12.9)	98	Φ10 Flat Washer
48	Ball Bearing 6206RS	99	Screws Ring Φ11×Φ9×Φ7×20
49	Crank Shaft	100	Screws Ring Φ11×Φ9×Φ7×15
50	Oil Tank Cover	801	Front Cover Subassembly
51	Deflating Valve	802	Cylinder Subassembly
52	Wool block 1	803	Piston&Connecting Subassembly
52.1	Wool block 2	804	Housing Subassembly
53	Bottom Cover		